

BODY POST INSTALLATION & BODY MOUNTING

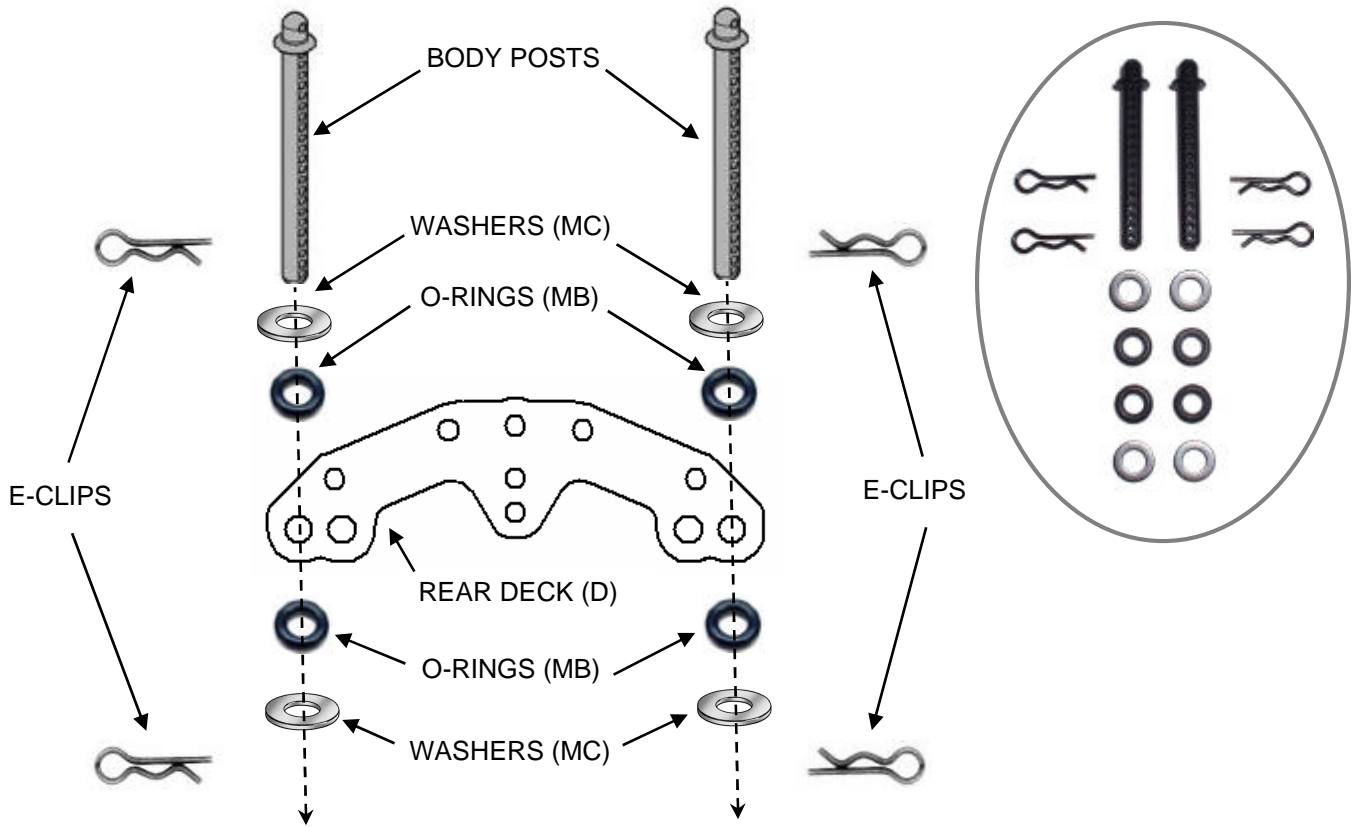

Install body posts into rear deck using (4) o-rings and (4) washers as shown.

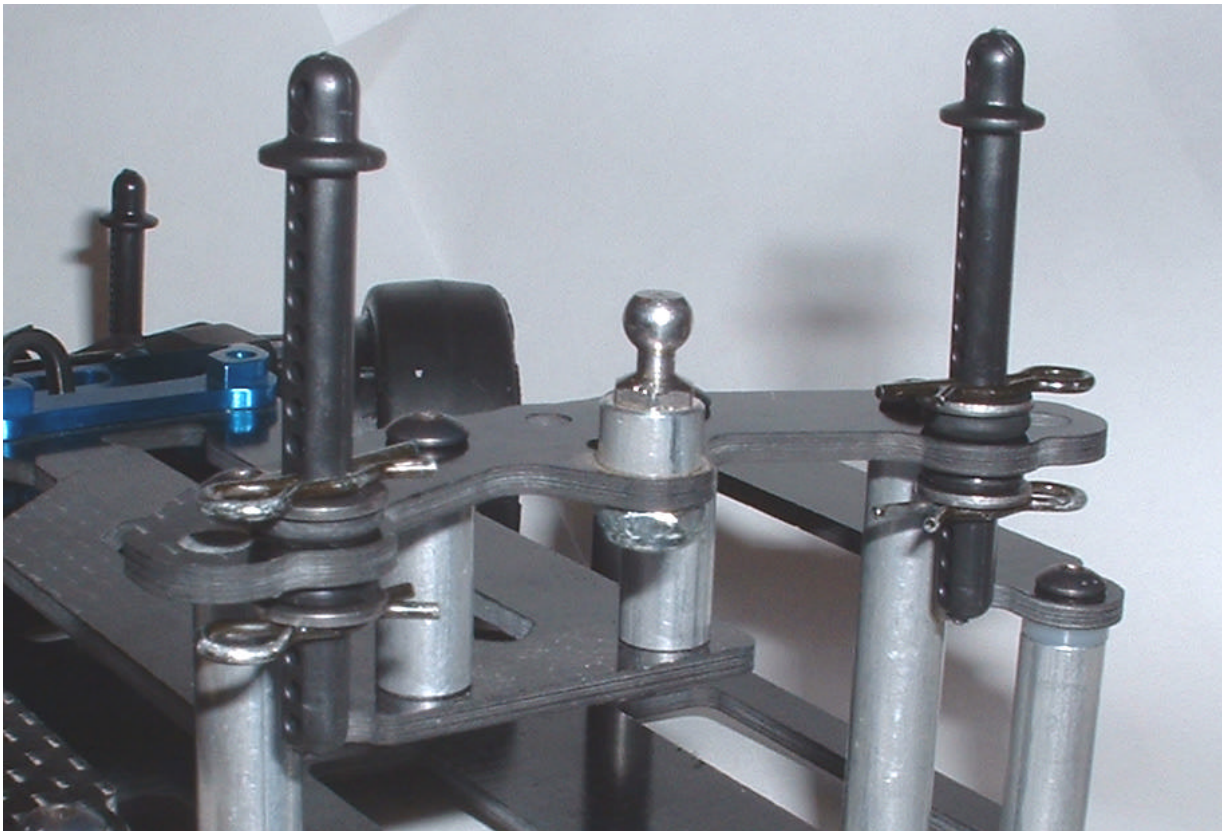

Once installed, body posts should look like this (body posts and e-clips not included in kit).

Line up the front body posts with the markings on the body or if there are no body post markings, line up the wheels so they sit within the markings for the wheel wells. Mark the new body post locations with a Sharpie on your car body before painting it so you can easily see where to make the holes.



The new body post locations are about 2.25" [57mm] further up from the stock body post locations and are slightly wider apart. On most bodies this new location will end up being somewhere near the upper part of the back window towards the top part of the body.

You may choose to either use the inner or outer holes on the rear deck for the body posts and depends on the body you will be using. In some cases the body posts installed in the outer holes may end up being too close to the sides of the body, in which case you would want to use the inner holes.

Here's a short list of bodies that fit on any of our x3 Series Conversion Kits:

Proline Mazda6
Proline F360 Modena
Bolink Camaro
Bolink Mustang
RAD CLK-GTR
RAD Lambo SE

HPI Mercedes CLK
HPI Corvette C5-R
HPI Murcielago
Various BRP Bodies
HomeR 959C
HomeR GTR

After you have painted your body, cut the appropriate holes and mount the body to your chassis like normal and secure with e-clips (body clips).